

Aunts Creek Area
TABLE ROCK LAKE

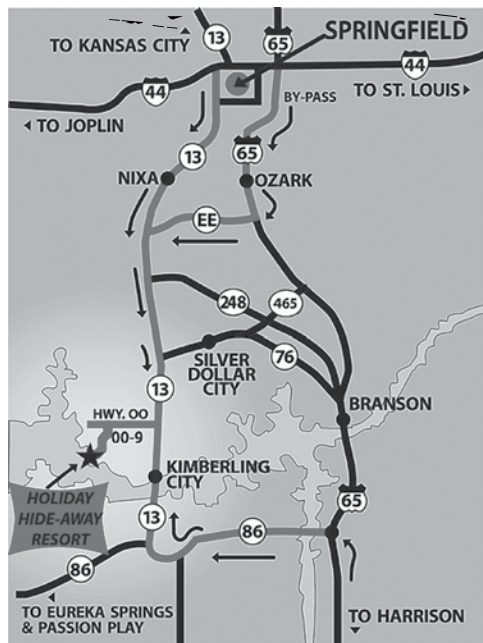

DELUXE 3 BEDROOM #15

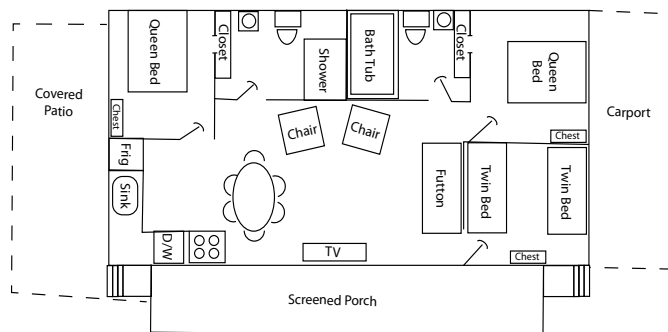

2 BEDROOM INDIVIDUAL #5-11

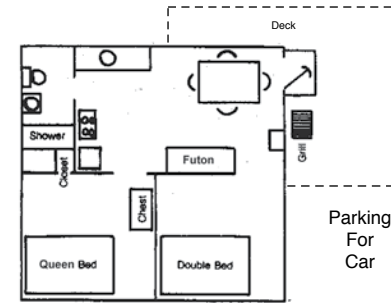

2 BEDROOM DUPLEX #1-4

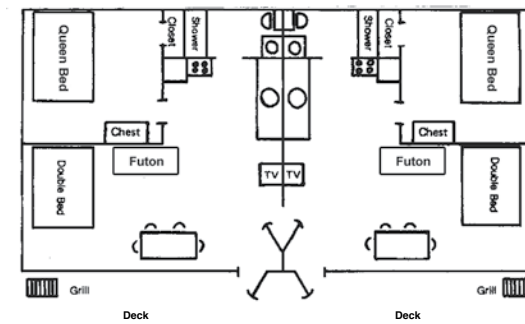

4 BEDROOM #00

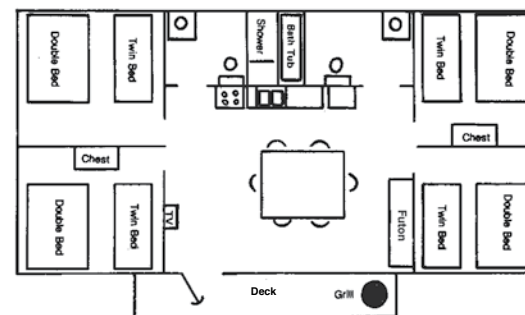

DELUXE 2 BEDROOM 2 BATH #12

DELUXE 2 BEDROOM 1 1/2 BATH #14

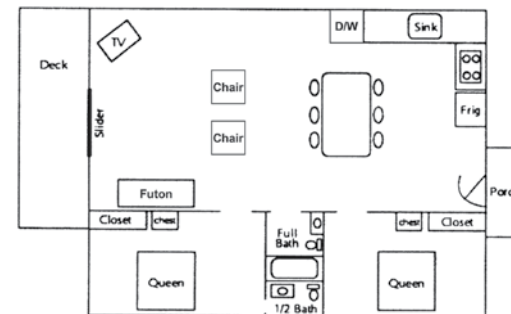

Aunts Creek Area



Your Hosts: Carl and Sue Sieveking
Holiday Hide-Away Resort
 10 Holiday HideAway Court
 Branson West, MO 65737
 (417) 739-4542

Website: www.holidayhideaway.com
Email: holidayhideaway@live.com
Facebook: Holiday Hideaway Resort

Directions to
Holiday Hide-Away Resort
From Springfield, MO
South on Highway 65
West on EE at Highlandville
South on Route 13
West on Highway OO
South on OO-9 to Resort
GPS: Latitude N36° 40.014',
Longitude W093° 27.7808'

Our Cabins

- Smoke free inside cabins
- Kitchenettes with dishes, pots & pans, toaster, coffee maker, microwave, refrigerator, stove with oven, bed linens and towels.
- Flat Panel Cable TV/DVD
- Lakeview deck
- Lawn chairs and picnic table
- BBQ grill
- Free wireless internet
- Air conditioning/heat
- Golf cart rentals

Our Pool Area

- Large in ground pool
- Baby/wading pool
- Large covered poolside cabana
- Game area including pool table, ping pong table, shuffleboard and foosball
- Horseshoe pit, volleyball & badminton area
- Fire pit
- Covered gathering area with tables and chairs

SORRY, NO PETS ALLOWED & SMOKE FREE INSIDE CABINS.

Check in time after 3:00 PM
Check out time before 10:00 AM

Our Dock

- Cement launch ramp
- 16 slip lighted, covered boat dock
- GFI electric outlets next to each slip
- Pontoon, ski and fishing boat rentals
- Gas sales available on dock
- Boat slips - \$12/day

Our Reservation Policy

Our reservation policy is intended to be fair to all our guests. We are a resort with a limited number of units. Once a guest reserves a unit we remove it from the market. Late arrivals and early departures will be charged for all days reserved.

Deposit refunded only if we are able to fill the vacancy completely.

Area Attractions

- Kimberling City - 4 miles
- Silver Dollar City - 9 miles
- Branson - 15 miles
- Eureka Springs - 35 miles
- Springfield/Bass Pro Shop - 50 miles
- Branson Landing/Bass Pro Shop - 20 miles

We sell fishing permits
See our Website for Specials
Fishing Guide referrals available

2018 Rates Summer Rates Memorial Day – Labor Day

Two Bedroom Duplex

Sleeps up to 6/side

Cabin # 1-4 Daily: \$95/side
*1-2 Guests Weekly: \$650/side

Two Bedroom Individual

Sleeps up to 6

Cabin # 5-11 Daily: \$100
*1-2 Guests Weekly: \$685

Deluxe Two Bedroom 2 Bath #12

Deluxe Two Bedroom 1 1/2 Bath #14

Sleeps up to 7

Cabin# 12 & 14 Daily: \$164
*1-4 Guests Weekly: \$1121

Deluxe Three Bedroom 2 Bath

Sleeps up to 8

Cabin# 15 Daily: \$216
*1-4 Guests Weekly: \$1480

Four Bedroom 2 Bath

Sleeps up to 12

Cabin # 00 Daily: \$214
*1-6 Guests Weekly: \$1465

***Additional Guests - \$12/night**

We reserve the right to limit the number of guests in a cabin.

2018 Rates Spring, Fall & Winter Rates

Two Bedroom Duplex

Sleeps up to 6/side

Cabin # 1-4 Daily: \$70/side
*1-2 Guests

Two Bedroom Individual

Sleeps up to 6

Cabin # 5-11 Daily: \$76
*1-2 Guests

Deluxe Two Bedroom 2 Bath #12

Deluxe Two Bedroom 1 1/2 Bath #14

Sleeps up to 7

Cabin# 12 & 14 Daily: \$130
*1-4 Guests

Deluxe Three Bedroom 2 Bath

Sleeps up to 8

Cabin# 15 Daily: \$179
*1-4 Guests

Four Bedroom 2 Bath

Sleeps up to 12

Cabin # 00 Daily: \$177
*1-6 Guests

***Additional Guests - \$12/night**

We accept cash, check, Visa, MC and Discover.
We require a deposit with your reservation.

Contact Resort or see our website for boat and golf cart rental information.